



Canterbury Powerflue ★ ★ ★ ★ ☆

5.5 star energy rated, the Powerflue is the ideal choice for the energy conscious. The double pipe system draws air from the outside for combustion and vents the flue gases outside.

Flexible flue options take Cannon built in heaters into new territory. See website for more details.

Clever design flaunts convention, letting you install it on any external wall, even in a multi-storey dwelling.

Standard Features

- + Electronic ignition and controls
- + 3 heat and fan speed settings
- + Realistic eucalypt look logs
- + Standard double glazed glass
- + Enhanced flame effect
- + Metallic Black Finish (CANTIB-PDEEB)
- + Platinum Finish (CANTIB-PDEEP)
- + Flexible flueing options
- + Supplied with 2 X 50mm diameter lengths of 400 mm aluminium flexible tubing, an insulating blanket and flue terminal
- + Heats 80 m² on average
- + Suitable for use in 5 star energy rated homes
- + Star energy rating: 5.5
- + 5 continuously monitored safety systems

Options

- + Canterbury mesh guard kit
- + Remote thermostat
- + Spacer kit
- + Weatherproof box
- + Surround kit
- + Console kit
- + Extended flue kit



CANTIB-PDEEB



CANTIB-PDEEP

Canterbury Powerflue heater specifications and dimensions

Models	CANTIB-PDEEB / CANTIB-PDEEP
Type	Inbuilt Powerflue with variable flue options
Colours	Metallic black baked enamel or platinum finish
Gas consumption	26 MJ/hr
Gas type	Natural gas/LPG
Efficiency rating	5.5 stars ¹ for units with flue 600 mm long
Heat output	6.42 kW / 23.11 MJ/h
Heats on average	80 square metres (80 m ²)
Fan/heat settings	3 speed / 3 heat

Dimensions	Fascia
Height	653 mm
Width	850 mm
Depth	125 mm

Installation

The purpose of these pages is to briefly illustrate the specifications. For full details refer to the comprehensive instructions included with the heater or visit www.cannonheaters.com.au. Whilst every effort is made to provide current information at the time this brochure was produced, continuing product development means that the enclosed specifications, images and literature may differ.

Gas connection via a 1/2" copper compression fitting.

A 10 amp socket within 1.5 m is required. Inbuilt models can be direct wired with an accessible double pole isolating switch

¹Tested to AS 4553:2008.

AVAILABLE FROM

Fireplace opening (brick & masonry)

	Max	Min
Height	640 mm	605 mm
Width	760 mm	700 mm
Depth	N/A	472 mm*

Dimensions of flue

Flue and air inlet through 50 mm diameter aluminium & PVC pipes
2 x 400 mm lengths of 50 mm flexible aluminium tubing.

Dimensions of flue terminal

Maximum length of flue: 6.0 m
Minimum length of flue: 130 mm
Flue terminal: 160 mm outer diameter,
150 mm deep (horizontal)
200 mm high (vertical)

See installation instructions for further details.

Mock Kit included with heater, may need to be removed from brick/masonry openings to allow fitment in openings less than 630 mm high.

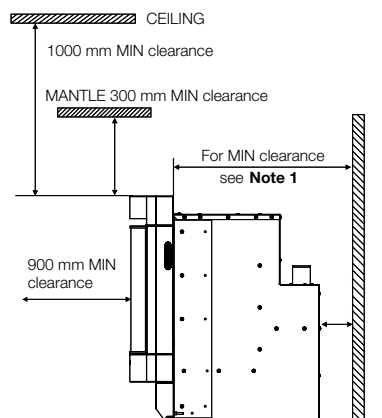

For further detailed flueing methods refer to our website for the installation instruction manual

Note 1:
472 mm min clearance for horizontal flueing.
522 mm min clearance for vertical flex flue tubing.

Note 2:
50 mm min clearance for horizontal flueing.
100 mm min clearance for vertical flex flue tubing.

For MIN clearance see **NOTE 2**

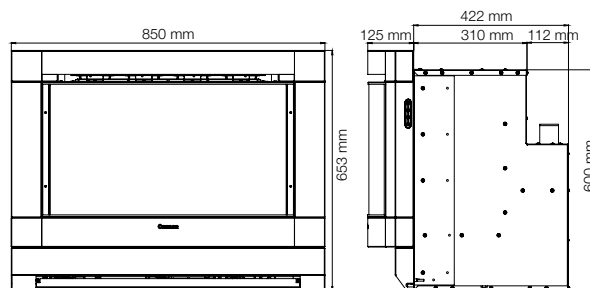
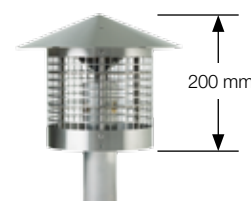
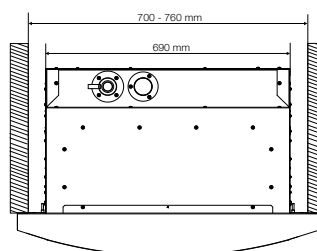

Mock Fireplace Opening (combustible materials)*

	Max	Min
Height	640 mm	630 mm
Width	760 mm	730 mm
Depth	N/A	472 mm*

*If you have a larger opening than the maximum height indicated, a surround kit is recommended. *Includes 25 mm clearance between back of heater and rear wall and allows 50mm clearance to bend flue in horizontal applications. We recommend 522 mm min depth in vertical flueing applications using flexible pipes. In the event space constraints inhibit the installation process, where it is not possible to maintain a 50mm or 100mm cavity depth clearance, for ease of installation these clearances can be reduced. However, under AS5601 guidelines a minimum clearance of 25mm to combustibles MUST be maintained at all times.



CRADLE MOUNTAIN FIREPLACES

T +61 3 6362 0922 F +61 3 6362 0999
sales@cradlemountainfireplaces.com.au
www.cradlemountainfireplaces.com.au